

**KEY PLAN**  
NOT TO SCALE

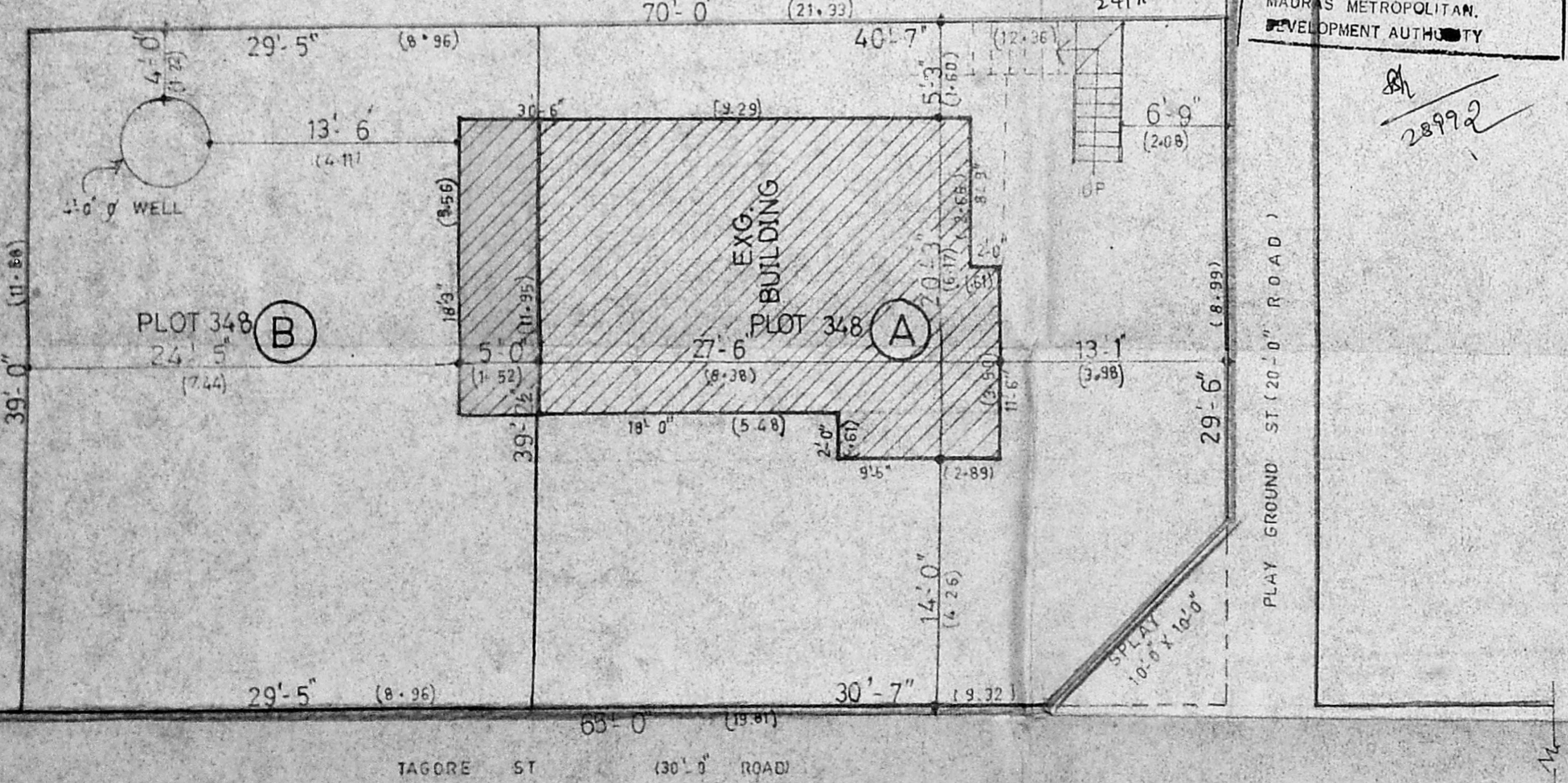

**APPROVED**  
 VIDE LR. NO. 21/14077/92  
 DTD 29.9.92  
 P.P.D. NO. 127/92  
 L.O. NO. 22457  
 P.P. NO. 22457  
 FOR MEMBER SECRETARY  
 MADRAS METROPOLITAN  
 DEVELOPMENT AUTHORITY



**DETAILS OF SUB-DIVISION**

PLAN SHOWING THE PROPOSED  
 SUB-DIVISION IN PLOT NO. 348 AT  
 PLAY GROUND ST, RAMAKRISHNA  
 NAGAR IN S.NO.116/1 OF VALASARA-  
 VAKKAM VILLAGE, MADRAS.

(SANCTIONED LAY OUT IN DTP NO. 25/69)

SCALE 1:100 (1" = 8'-0")

**REFERENCE**



**AREA DETAILS**

PLOT	(A)	1547.45	SFT
PLOT	(B)	1150.05	SFT
SPLAY		50.00	SFT
<b>TOTAL AREA</b>		<b>2747.50</b>	<b>SFT</b>

**OWNER** R. Lakshmanan

*N. Joachim Selvaraj, B.E.*  
 CONSULTING ENGINEER,  
 LICENSED SURVEYOR, CLASS I No. 85  
 & WATER DIVINER  
 APSARA MANSION  
 (OPPOSITE LIBERTY THEATRE)  
 KODAMBAYAN, MADRAS 600014  
 PHONE: 421451 (P.P.)

**LICENSED SURVEYOR**